

<b>A</b>	<b>Upper Left Frame</b>	<b>1</b>
<b>B</b>	<b>Upper Right Frame</b>	<b>1</b>
<b>C</b>	<b>Lower Left Frame</b>	<b>1</b>
<b>D</b>	<b>Lower Right Frame</b>	<b>1</b>
<b>E</b>	<b>Shelf 1</b>	<b>1</b>
<b>F</b>	<b>Shelf 2</b>	<b>1</b>
<b>G</b>	<b>Shelf 3</b>	<b>1</b>
<b>H</b>	<b>Top Panel</b>	<b>1</b>
<b>I</b>	<b>Left Side Panel</b>	<b>1</b>
<b>J</b>	<b>Right Side Panel</b>	<b>1</b>
<b>K</b>	<b>Bottom Panel</b>	<b>1</b>
<b>L</b>	<b>Fixed Shelf</b>	<b>1</b>
<b>M</b>	<b>Left Door</b>	<b>1</b>
<b>N</b>	<b>Right Door</b>	<b>1</b>
<b>O</b>	<b>Back Panel</b>	<b>1</b>

Please review the hardware listed on the next page as well as individual components of this product. As you unpack and prepare for assembly, place the contents on a carpeted or padded area to protect them from damage.

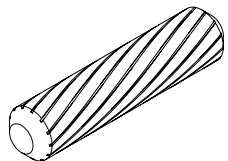

**H1 x 34  
WOODEN  
DOWEL**

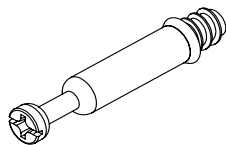

**H2 x 12  
CAM  
BOLT**

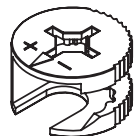

**H3 x 12  
CAM**

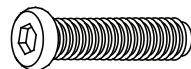

**H4 x 22  
SMALL  
BOLT**



**H5 x 4  
LARGE  
BOLT**

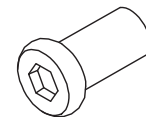

**H6 x 4  
BINDING  
SCREW**

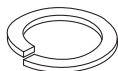

**H7 x 4  
LOCK  
WASHER**

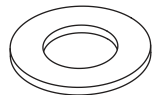

**H8 x 4  
WASHER**



**H9 x 4  
HINGE**

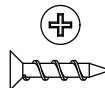

**H10 x 24  
SMALL FLAT  
HEAD SCREW**

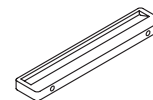

**H11 x 2  
PULL**



**H12 x 4  
PULL  
BOLT**

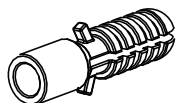

**H13 x 1  
WALL  
ANCHOR**

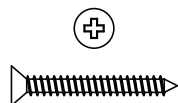

**H14 x 1  
FLAT HEAD  
SCREW**

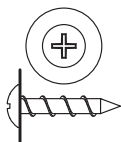

**H15 x 1  
TRUSS HEAD  
SCREW**



**H16 x 1  
WALL  
STRAP**

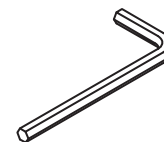

**H17 x 2  
ALLEN  
WRENCH**

**TOOLS REQUIRED: PHILLIPS SCREWDRIVER | HAMMER**

1

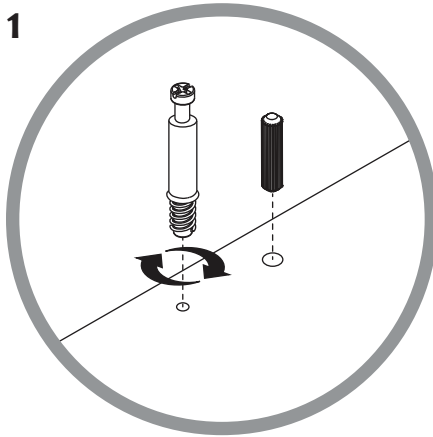

2

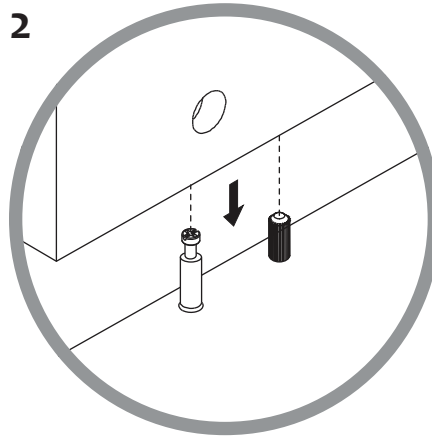

3

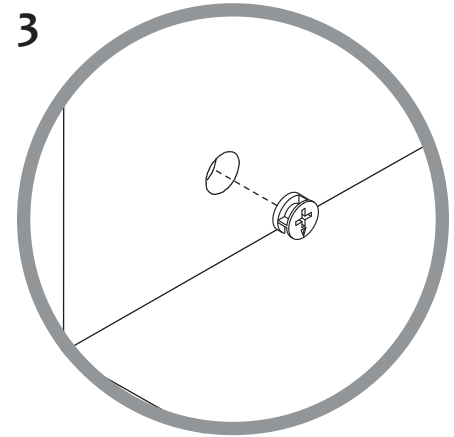

4

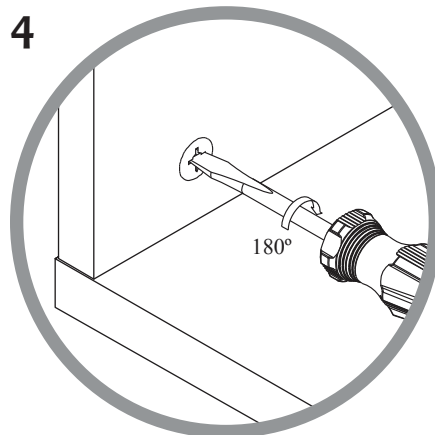

5

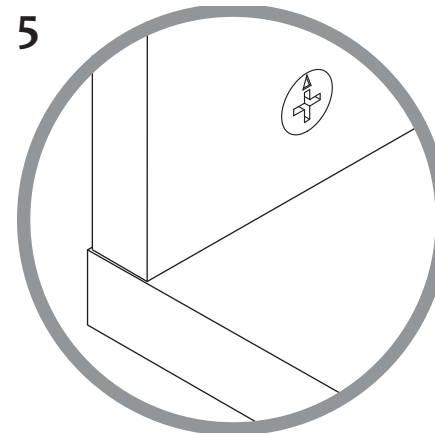

## STEP 1

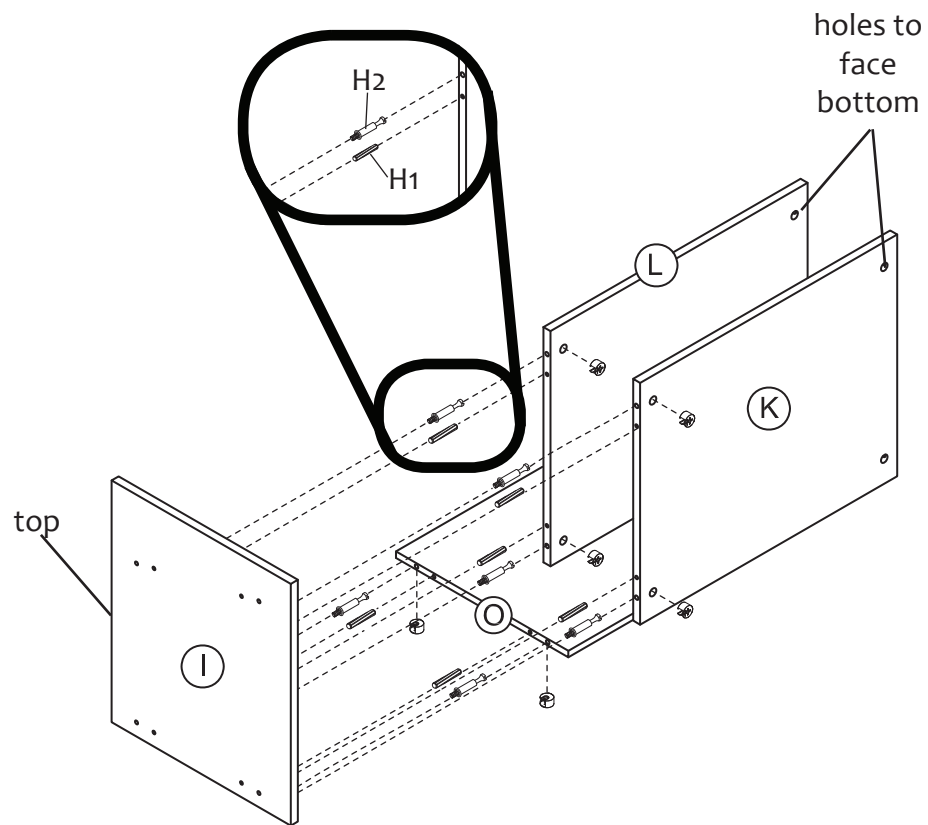

## STEP 2

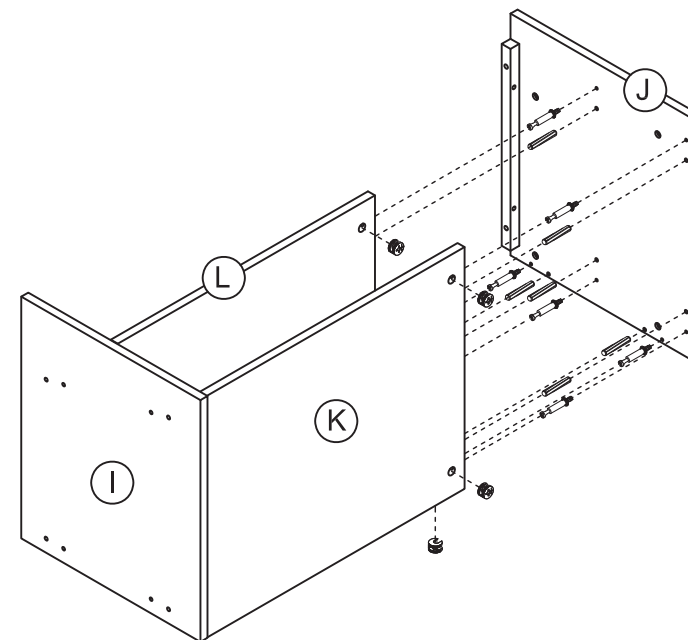

### STEP 3

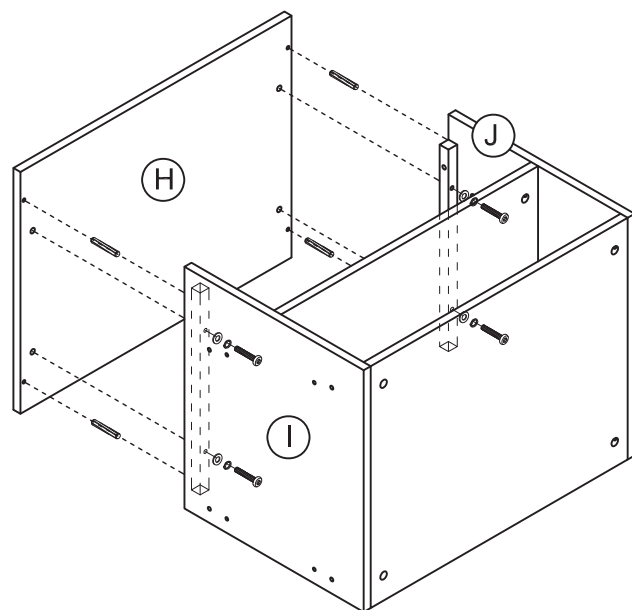

**H1 x 4  
WOODEN  
DOWEL**



**H4 x 4  
SMALL  
BOLT**



**H7 x 4  
LOCK  
WASHER**



**H8 x 4  
WASHER**



**H17 x 1  
ALLEN  
WRENCH**

### STEP 4

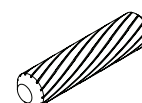
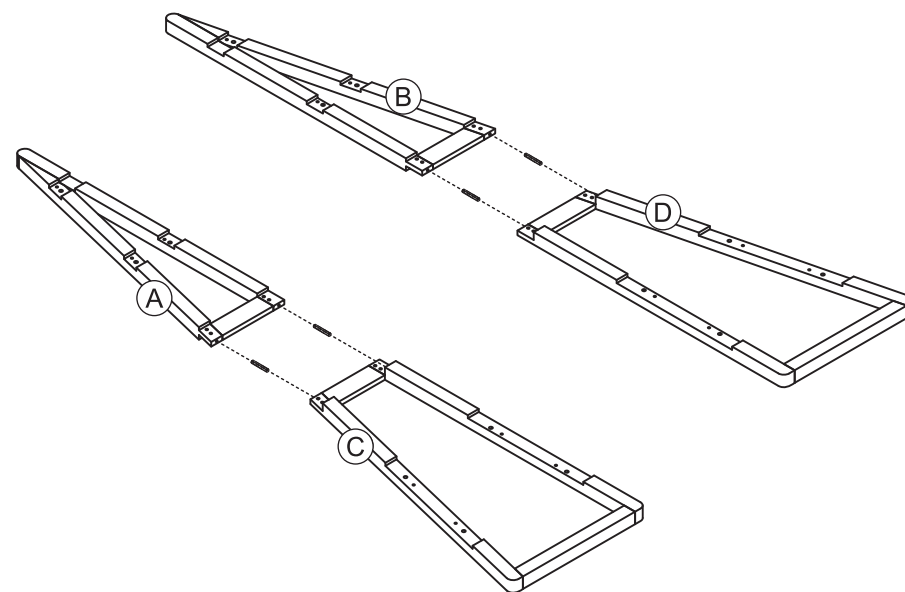

**H1 x 4  
WOODEN  
DOWEL**

## STEP 5

Ensure all dowels are installed before tightening bolts.

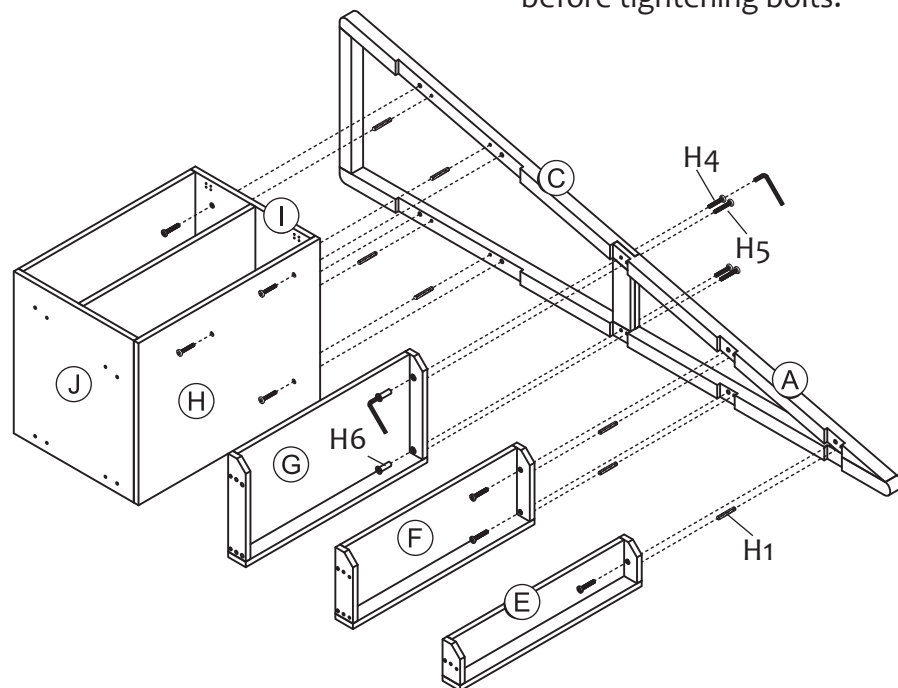

For best results begin by installing shelf G.

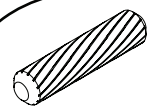

**H1 x 7  
WOODEN  
DOWEL**



**H4 x 9  
SMALL  
BOLT**

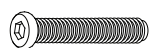

**H5 x 2  
LARGE  
BOLT**



**H6 x 2  
BINDING  
SCREW**

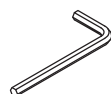

**H17 x 2  
ALLEN  
WRENCH**

## STEP 6

Ensure all dowels are installed before tightening bolts.

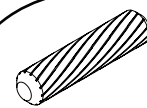
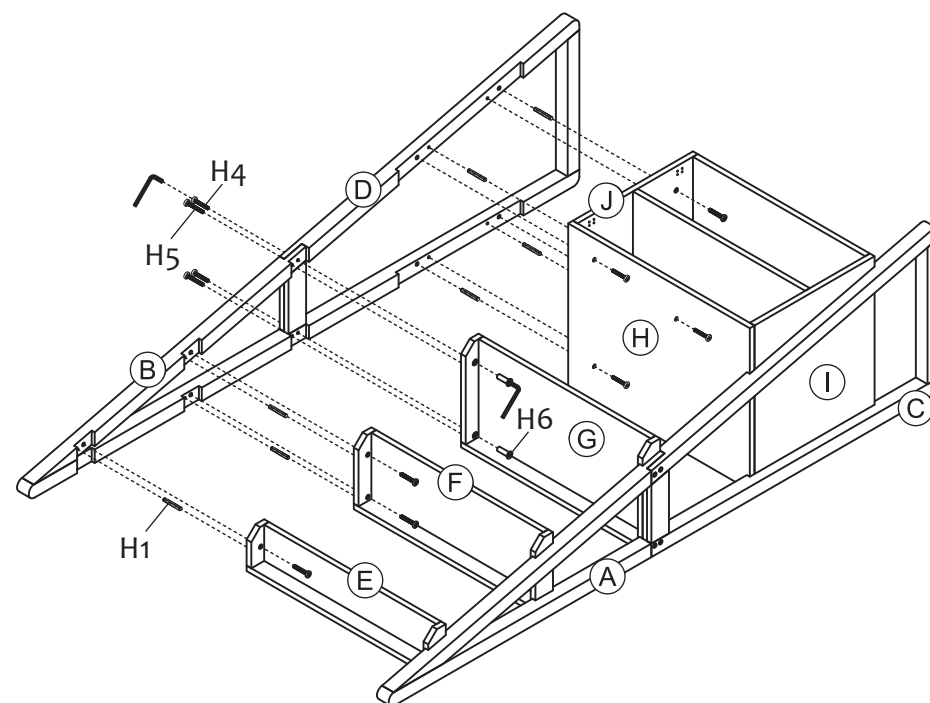

**H1 x 7  
WOODEN  
DOWEL**

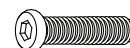

**H4 x 9  
SMALL  
BOLT**

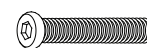

**H5 x 2  
LARGE  
BOLT**



**H6 x 2  
BINDING  
SCREW**

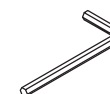

**H17 x 2  
ALLEN  
WRENCH**

## STEP 7

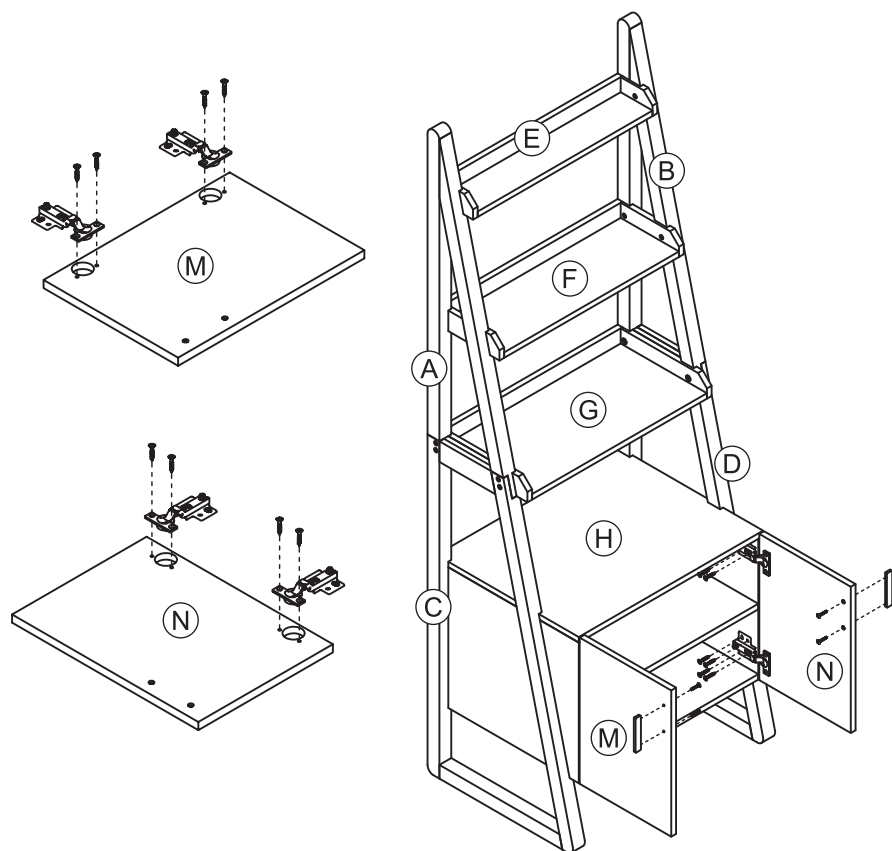

**H9 x 4  
HINGE**

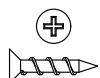

**H10 x 24  
SMALL FLAT  
HEAD SCREW**

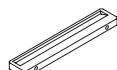

**H11 x 2  
PULL**



**H12 x 4  
PULL  
BOLT**

## STEP 8

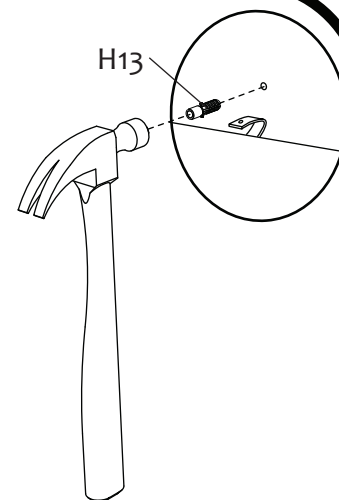
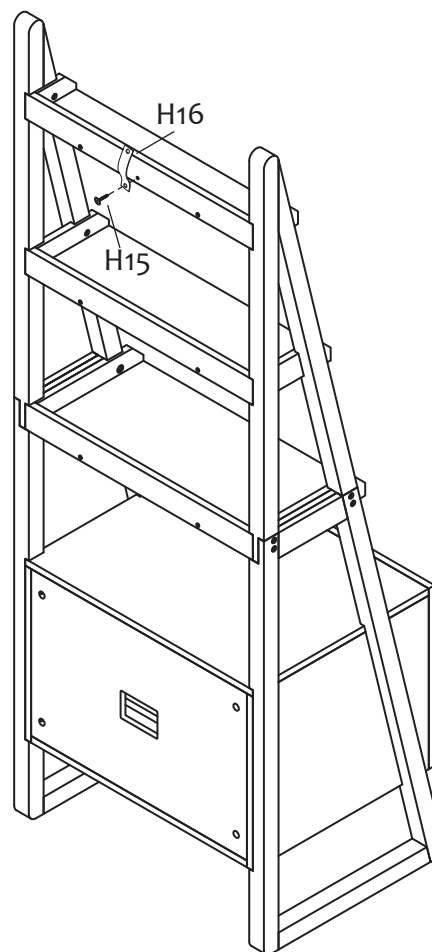

Position against wall  
Mark position of strap hole  
on wall  
Drill 1/4" hole  
tap in wall anchor

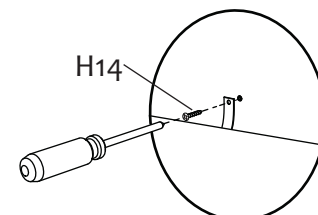

Fasten anti-tip strap with  
wall screw provided



**H13 x 1  
WALL  
ANCHOR**

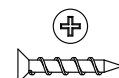

**H14 x 1  
FLAT HEAD  
SCREW**



**H15 x 1  
TRUSS HEAD  
SCREW**



**H16 x 1  
WALL  
STRAP**



## DOOR ADJUSTMENT

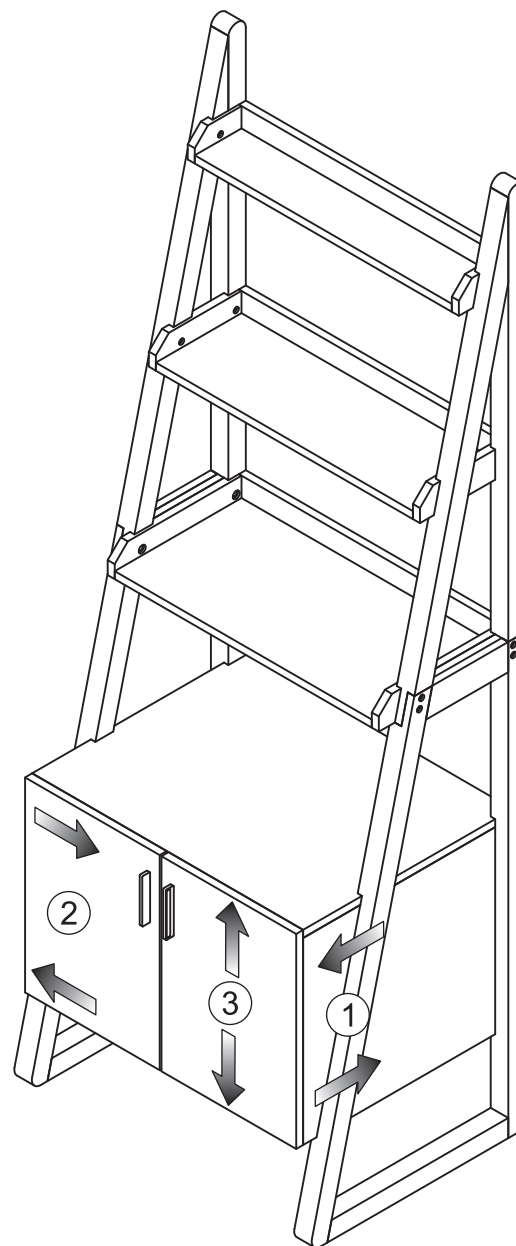
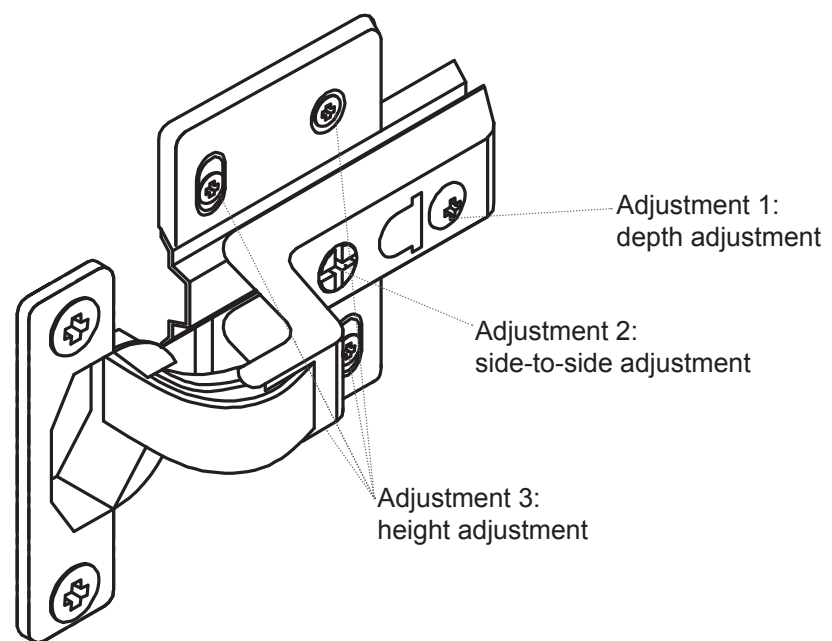

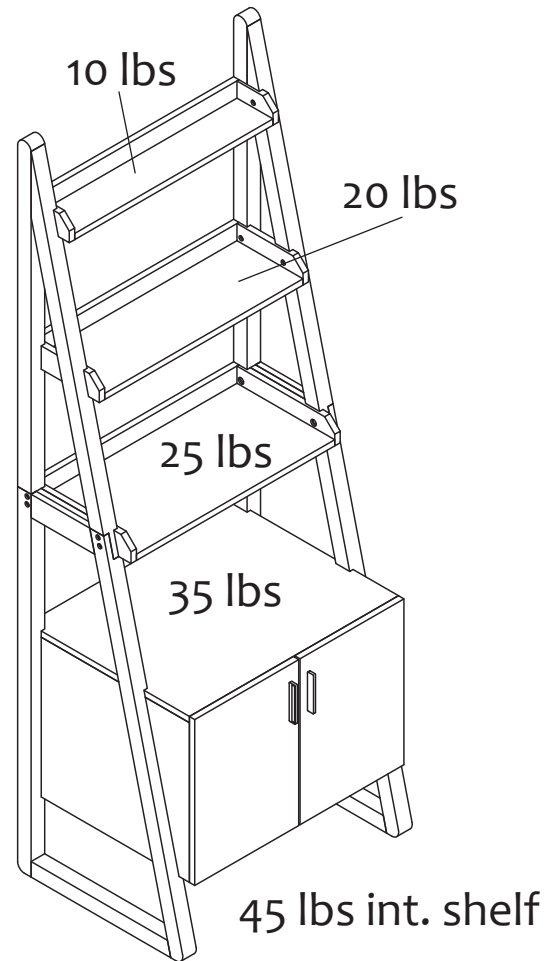

**WARNING:** Do not exceed the recommended weight limits on the designated panels. Exceeding these limits could cause sagging, possibly resulting in failure of product or bodily injury. Severe injury may occur if furniture tips over. Never allow children to climb or play on this product. Place heaviest items on lower shelves and as far back as possible, never overload product.