

A	Top Panel	1
B	Left Side Panel	1
C	Right Side Panel	1
D	Back Panel	1
E	Upper Rail	1
F	Lower Rail	1
G	Cushion	1
H	Drawer Front	2
I	Left Drawer Side	2
J	Right Drawer Side	2
K	Drawer Back	2
L	Drawer Bottom	2
M	Drawer Support	2

Please review the hardware listed on the next page as well as individual components of this product. As you unpack and prepare for assembly, place the contents on a carpeted or padded area to protect them from damage. A second person is required for assembly.

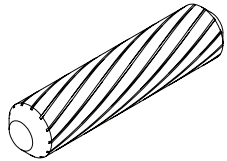

**H1 x 24
WOODEN
DOWEL**

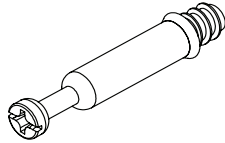

**H2 x 14
CAM
BOLT**

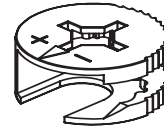

**H3 x 14
CAM**

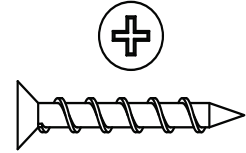

**H4 x 20
25mm
FLATHEAD
SCREW**

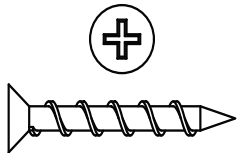

**H5 x 2
38mm
FLATHEAD
SCREW**

REQUIRED FOR ASSEMBLY:

PHILLIPS SCREW DRIVER / TWO PEOPLE

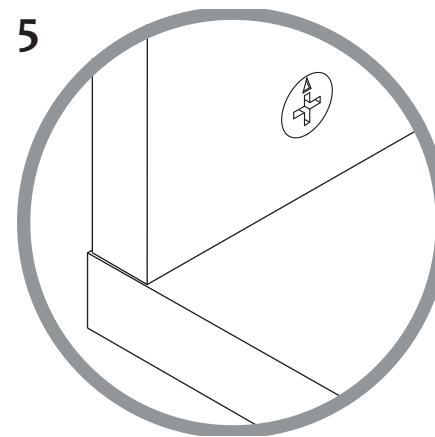
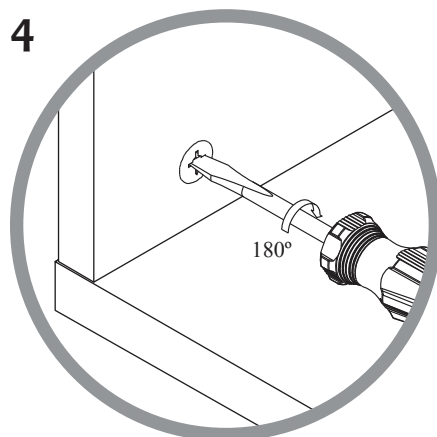
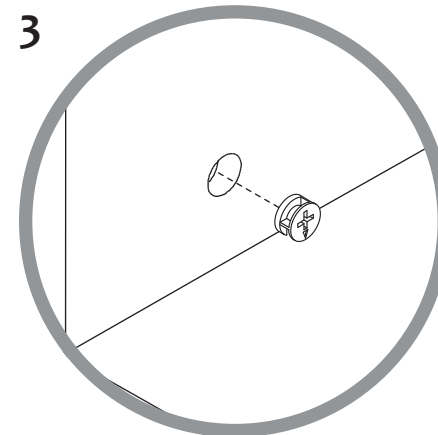
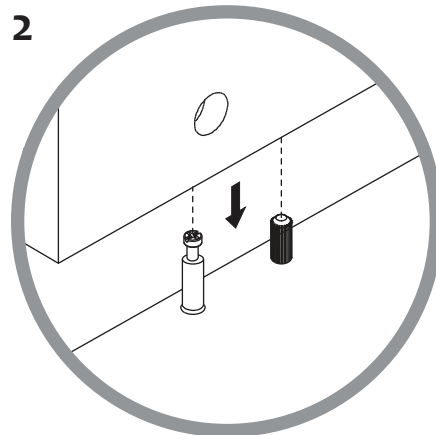
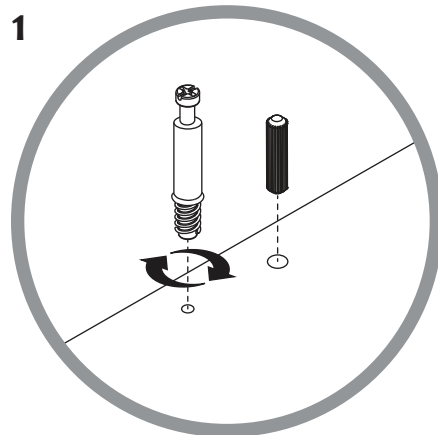

STEP 1

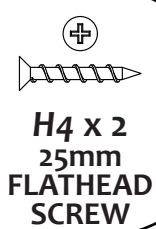
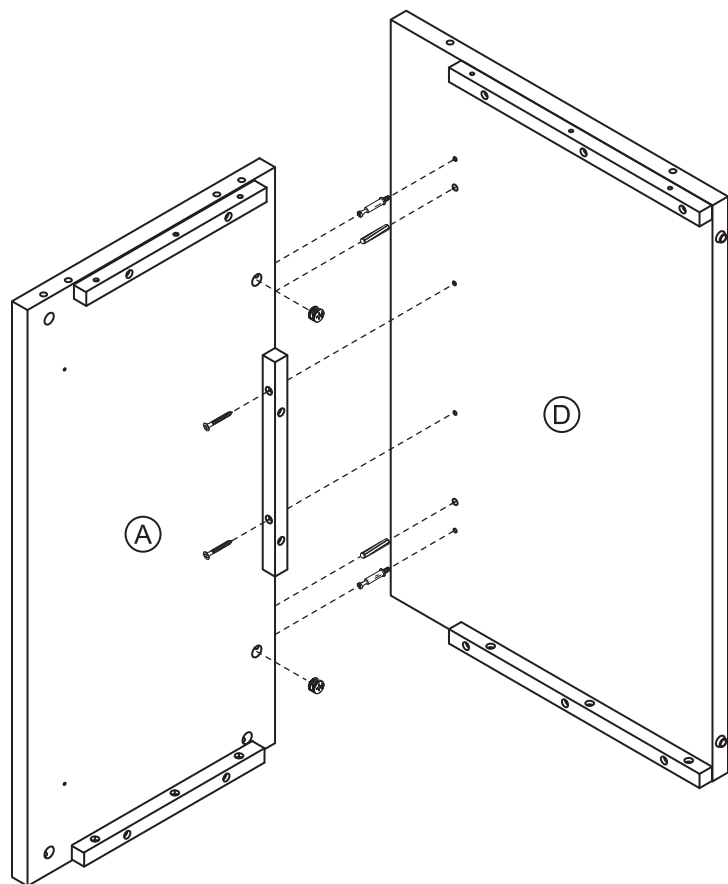

STEP 2

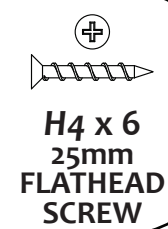
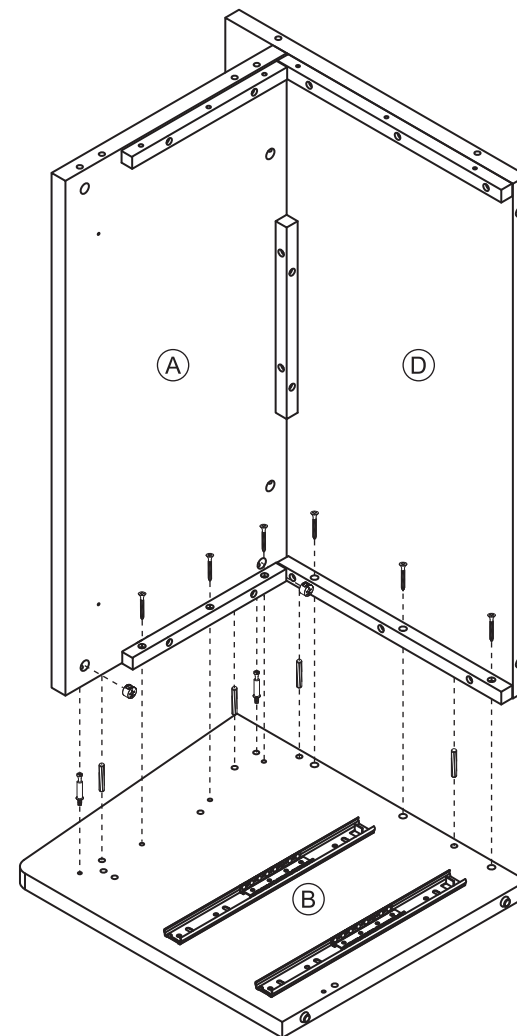

STEP 3

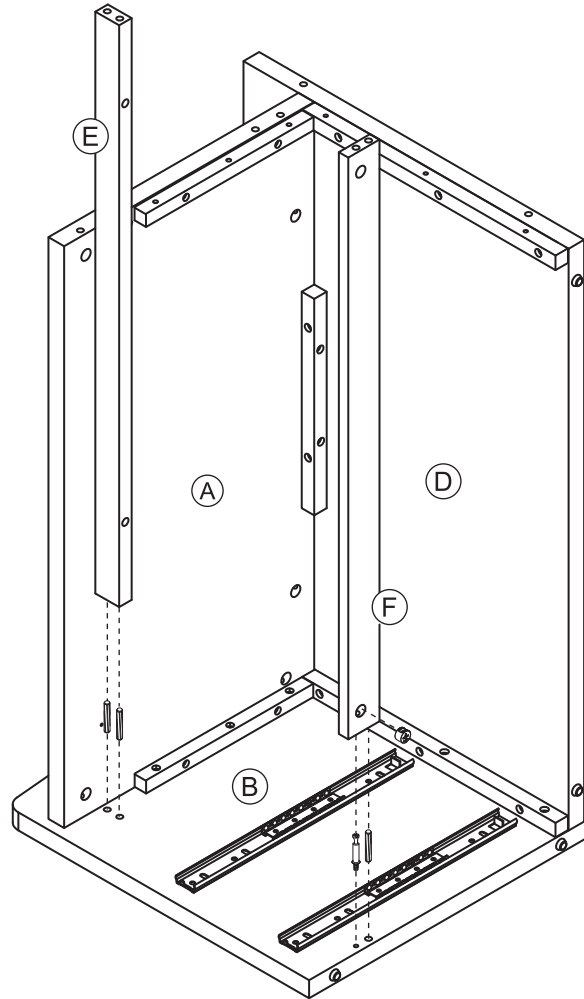

H1 x 3
WOODEN
DOWEL

H2 x 1
CAM
BOLT

H3 x 1
CAM

STEP 4

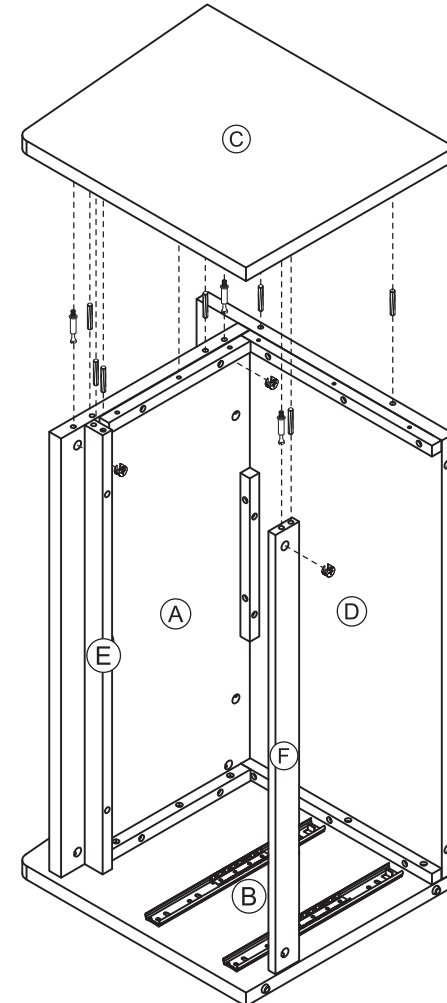

H1 x 7
WOODEN
DOWEL

H2 x 3
CAM
BOLT

H3 x 3
CAM

STEP 5

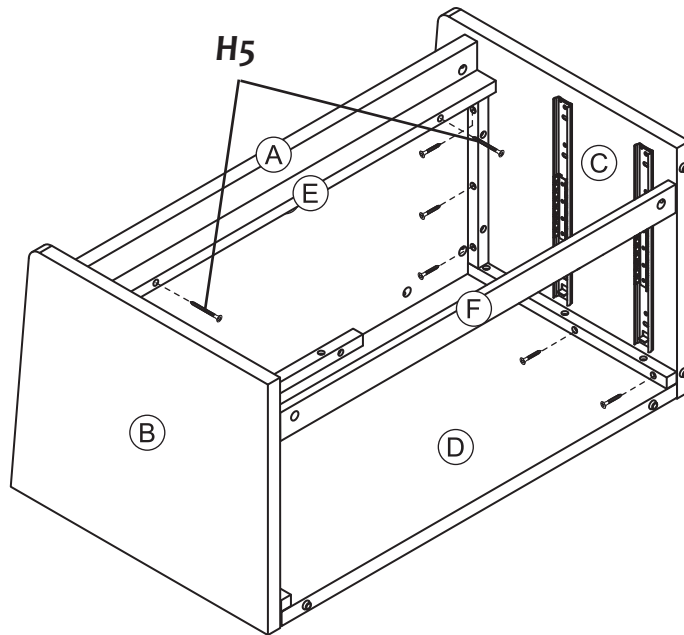

H4 x 6
25mm
FLATHEAD
SCREW

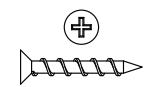
H5 x 2
38mm
FLATHEAD
SCREW

STEP 6

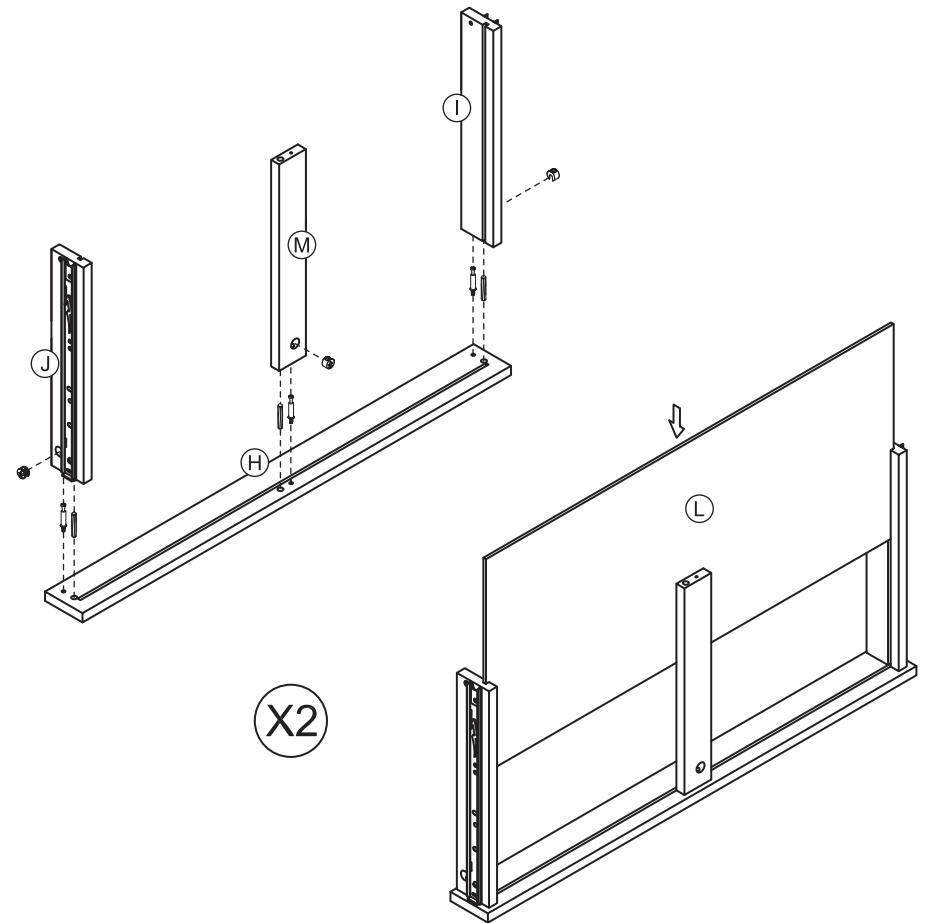



H1 x 6
WOODEN
DOWEL

H2 x 6
CAM
BOLT

H3 x 6
CAM

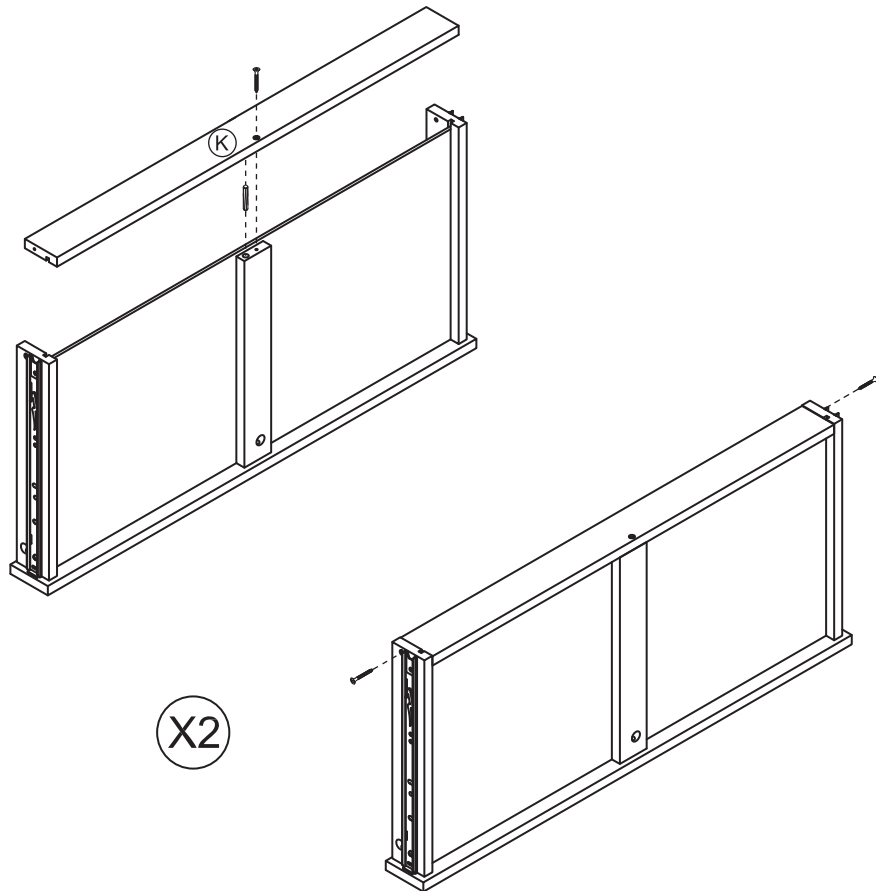
STEP 7



H1 x 2
WOODEN
DOWEL

H4 x 6
25mm
FLATHEAD
SCREW

STEP 8

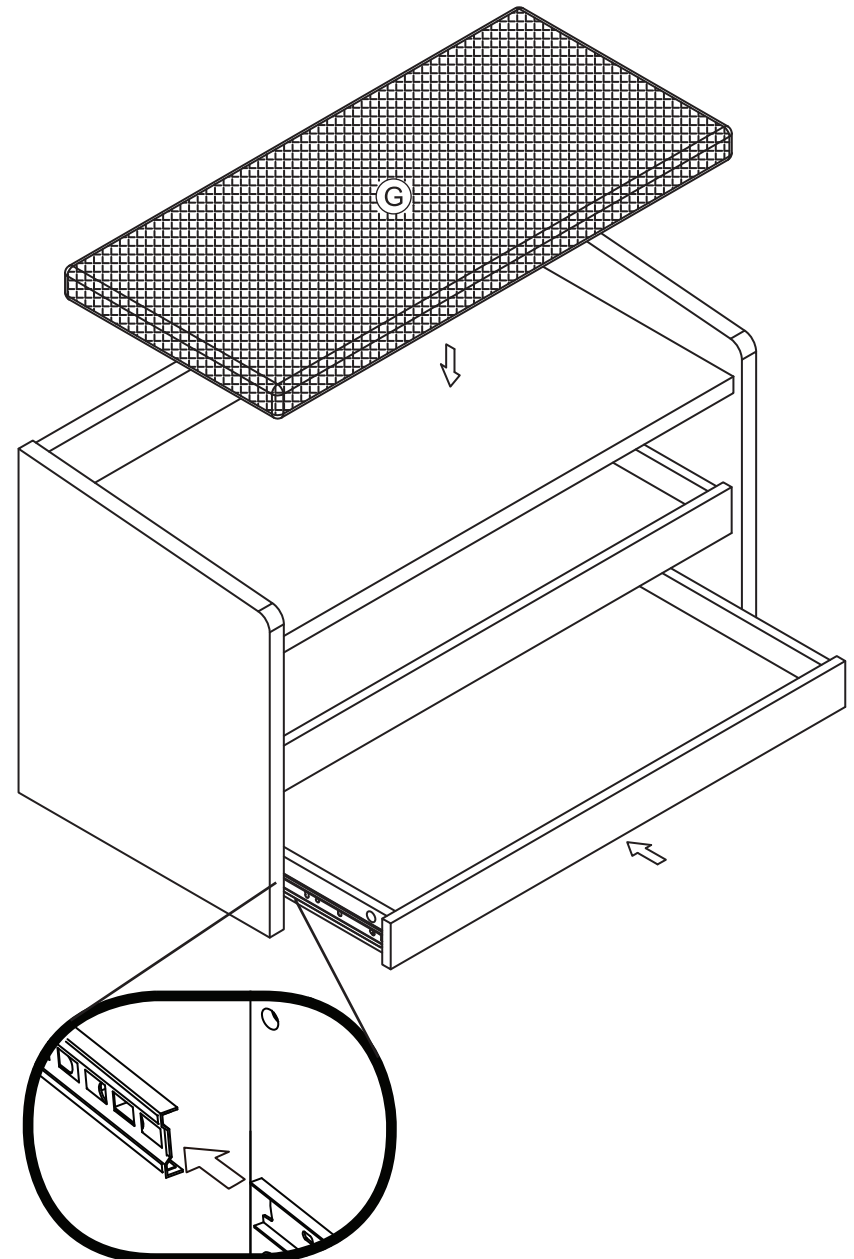

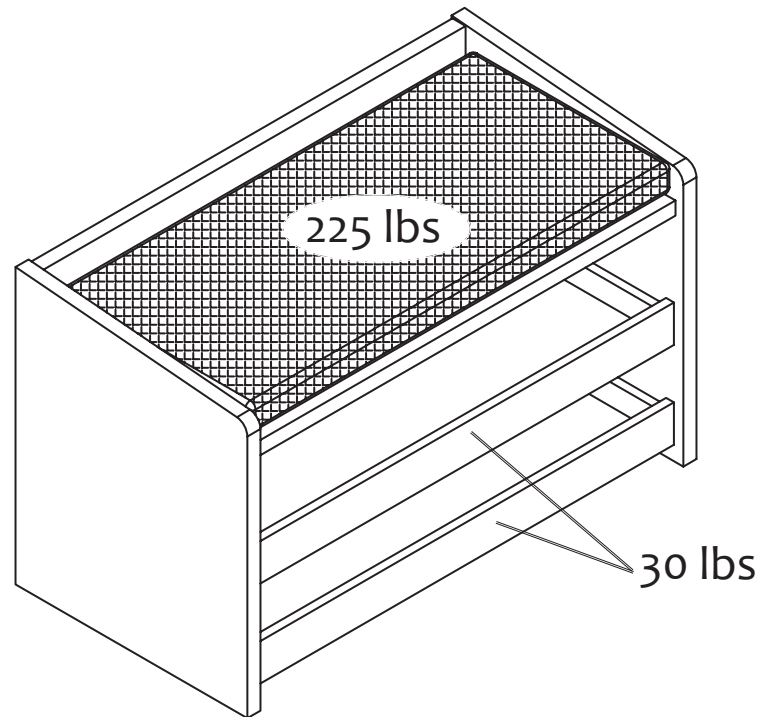

WARNING: Do not exceed the recommended weight limits on the designated panels. Exceeding these limits could cause sagging, possibly resulting in failure of product or bodily injury. Severe injury may occur if furniture tips over. Never allow children to climb or play on this product. Place heaviest items on lower shelves and as far back as possible, never overload product.