

A

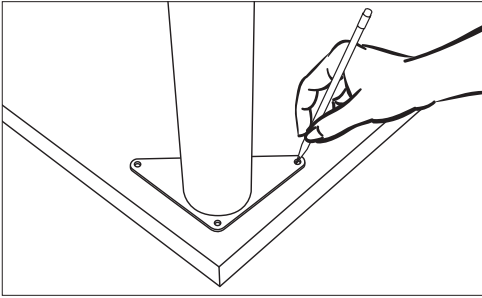

B

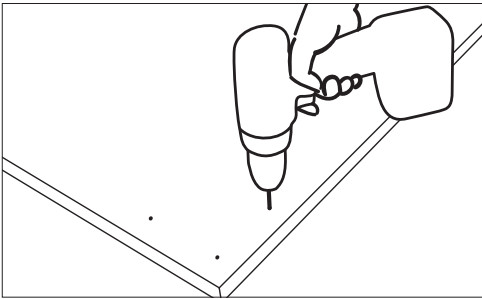

C

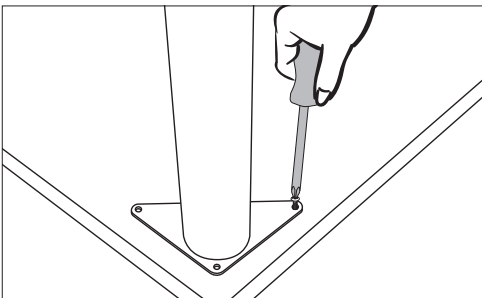

D

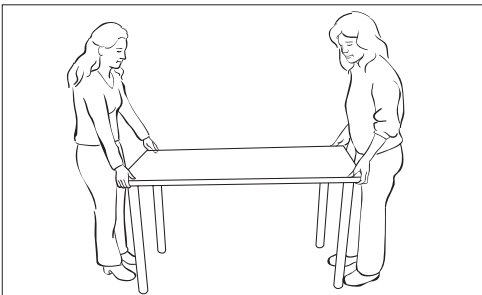

Tools needed: pencil, drill, 1/8" drill bit, #2 Phillips screwdriver, tape measure, plastic mallet

TIP

There is not a designated top or bottom to the Desk Top. If using two file cabinets or Drawer Units, there is no need to install Desk Legs.

A Attach Desk Legs

- Place the Desk Top on the floor and measure 1" from each corner edge to determine the placement of the Desk Legs.
- Mark all three holes of each Desk Leg with a pencil on each corner of the Desk Top.

B Drill Pilot Holes

- Drill a pilot hole with a 1/8" drill bit. You should drill just enough to break through the surface of the Desk Top. Repeat for all three holes for each Desk Leg.

C Secure Desk Legs

- Secure the Desk Leg with the screws provided using a Phillips screwdriver.
- Repeat for all Desk Legs that will be used.
- If using four Desk Legs, installation is complete.
- If using an Elfa Drawer Solution or File Cabinet instead of Desk Legs, proceed to page 2 or 3.

D Flip Desk Over

- It's best to have two people to flip the desk over carefully. Do not use Desk Legs as leverage when turning the desk right side up.

A

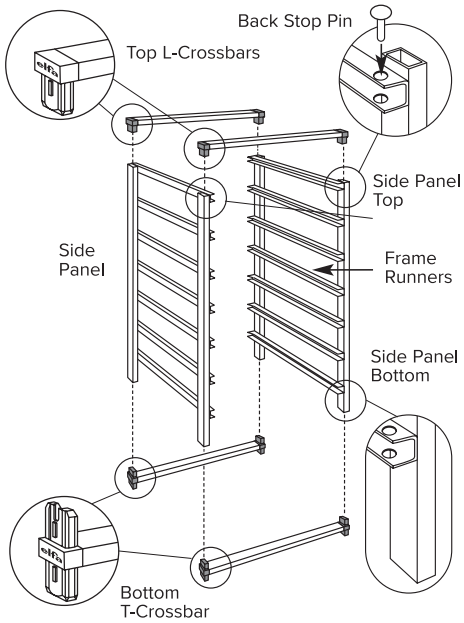

Tools needed: plastic mallet

TIP

If you don't have a plastic mallet, you can use a hammer with a wood block to protect the Frame.

A To build Elfa Frames and Drawers

- Position the Elfa Frame Runners facing inward.
- Using a plastic mallet, tap the Bottom T-Crossbars into the bottom of each Side Panel. (The notched side goes into the frame.)
- Flip the unit over, and if using Back Stop Pins, put a Back Stop Pin in each of the back holes of the top Frame Runners before inserting the Top L-Crossbars. To keep Pins from "jumping" out of the hole while tapping the Top L-Crossbars in place, cover with a piece of tape.
- Using your mallet, tap the Top L-Crossbars completely into each Side Panel.
- Insert the remaining Back Stop Pins.

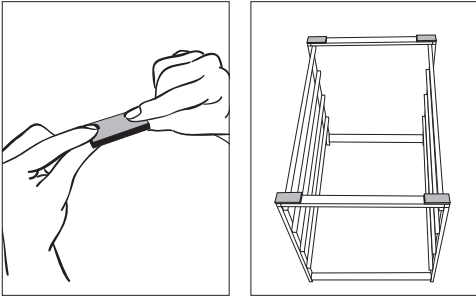
B**TIP**

If using Desk Legs in addition to a Drawer Solution or File Cabinet, attach the Desk Legs first following the steps on page 1.

B To attach an Elfa Drawer Solution or File Cabinet to the Desk Top

- Place adhesive strips provided in the packaging on the top L-Crossbars.

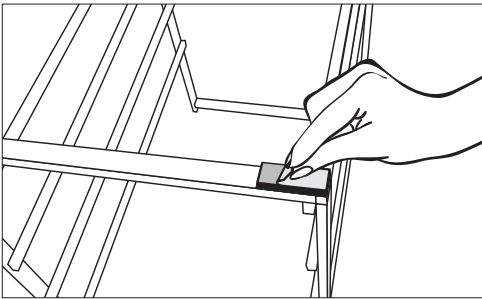
C**C Remove Protective Backing**

- Remove the protective backing from the adhesive strip that's facing up.

D Position Desktop

- Without pressing the Desk Top to the adhesive, position the Desk Top so the Drawer Frame or File Cabinet is about 1" from the edge of the Desk Top. This will ensure you leave enough leg room.
- When satisfied with the positioning of the Desk Top, press firmly to secure.

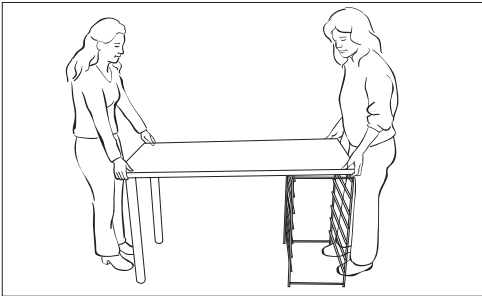
D**E Drawers Into Frame**

- Slide the Drawers into the Frame.

E