

Assembly Instructions

Copenhagen Low Wide Bookshelf

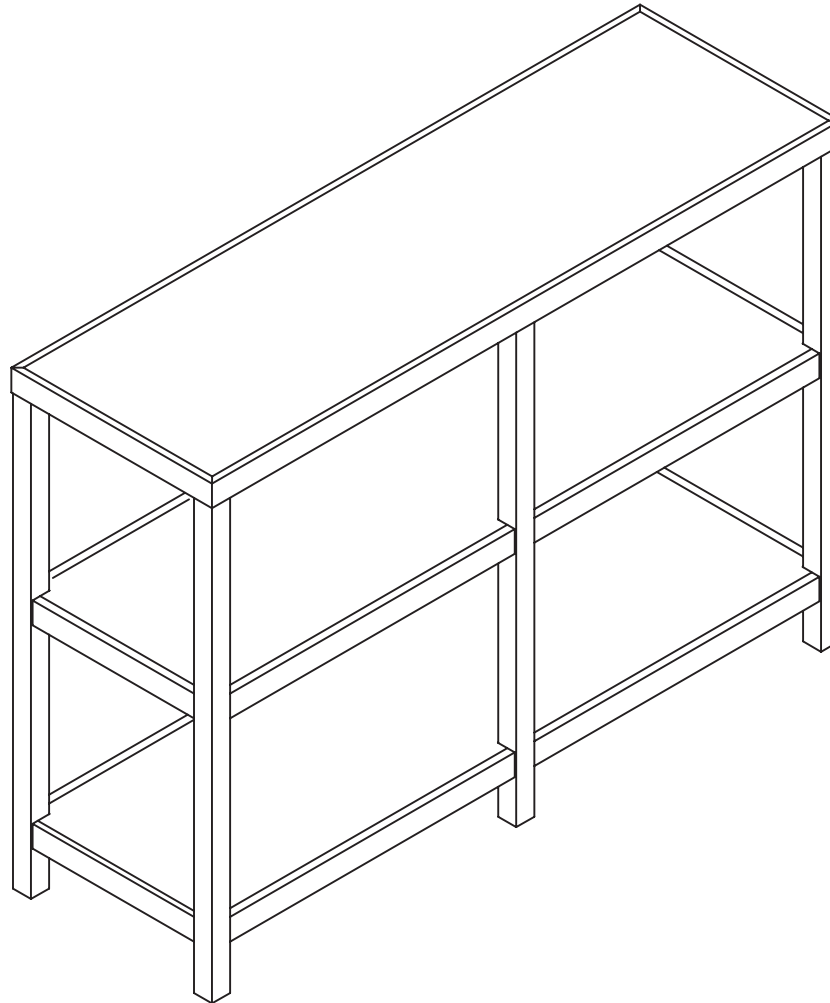

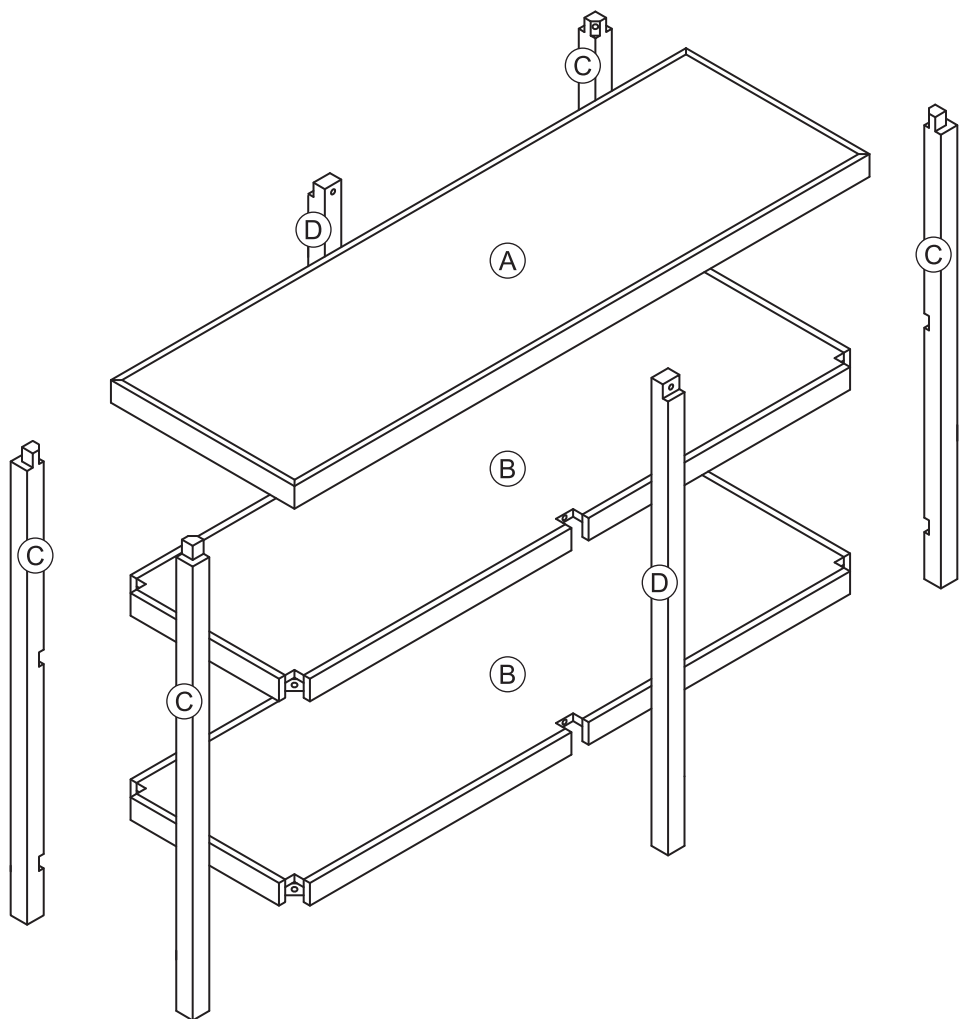

A	Top Shelf	1
B	Fixed Shelf	2
C	Outside Legs	4
D	Center Legs	2

Please review the hardware listed on the next page as well as individual components of this product. As you unpack and prepare for assembly, place the contents on a carpeted or padded area to protect them from damage.

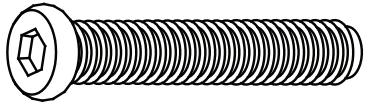

H1 x 12
LARGE BOLT



H2 x 2
SMALL BOLT

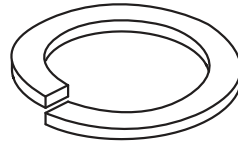

H3 x 14
LOCK WASHER

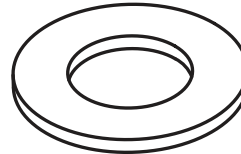

H4 x 14
WASHER

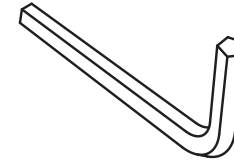

H5 x 1
**ALLEN
WRENCH**

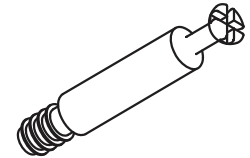

H6 x 4
CAM BOLT

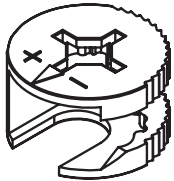

H7 x 4
CAM

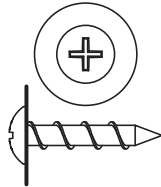

H8 x 1
**TRUSS HEAD
SCREW**



H9 x 1
WALL STRAP

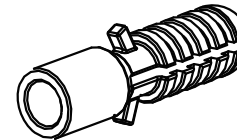

H10 x 1
WALL ANCHOR

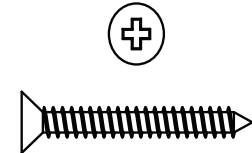

H11 x 1
WALL SCREW

TOOLS REQUIRED: PHILLIPS SCREW DRIVER / DRILL / HAMMER

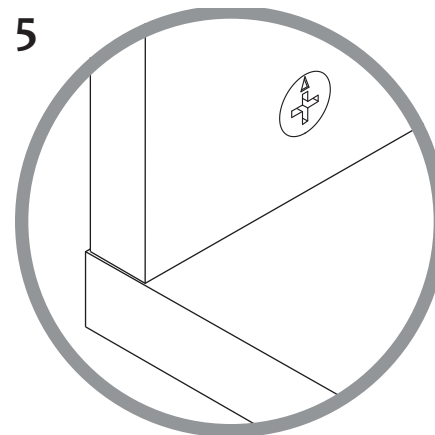
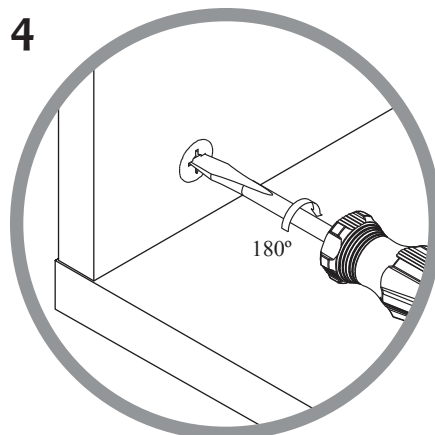
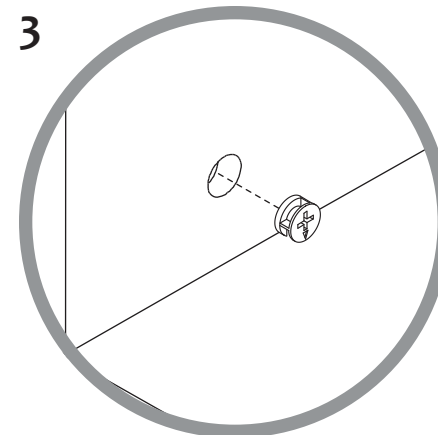
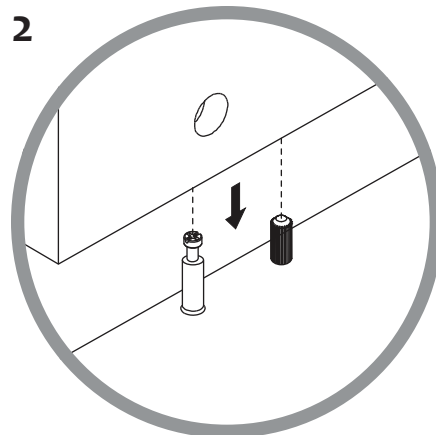
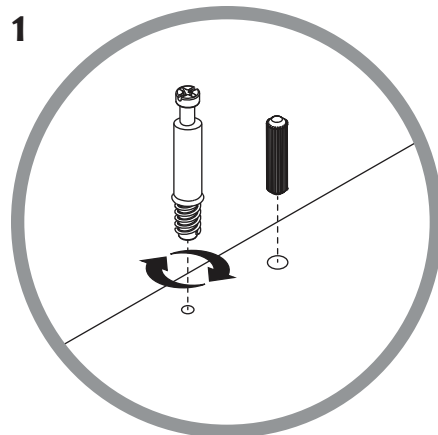

STEP 1

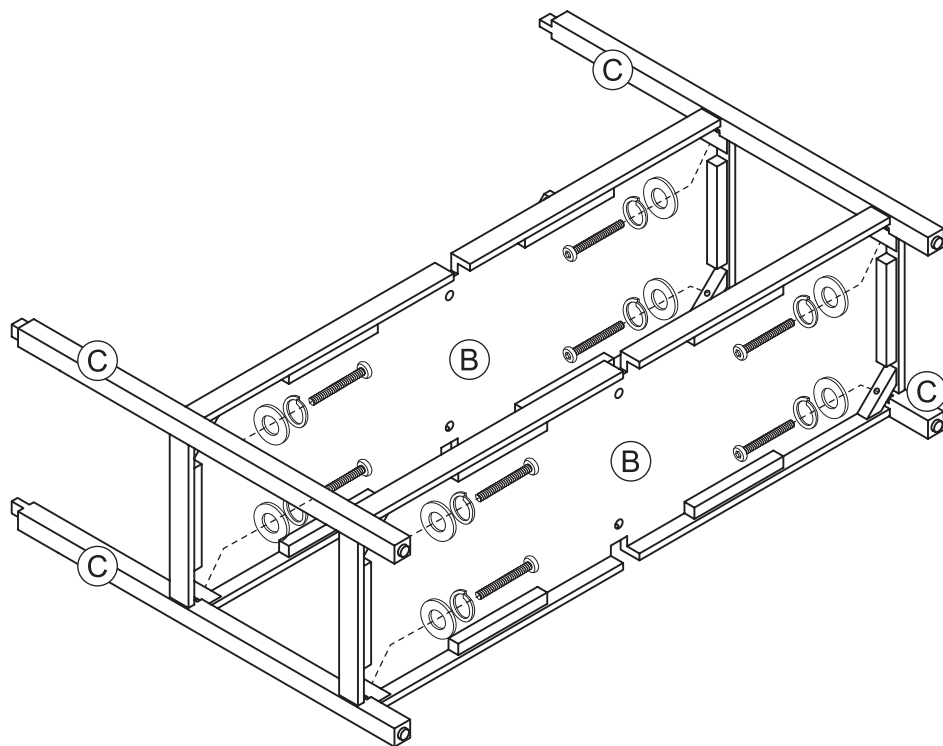

**H1 x 8
LARGE-
BOLT**

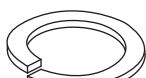

**H3 x 8
LOCK
WASHER**

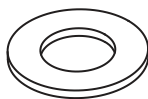

**H4 x 8
WASHER**

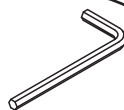

**H5 x 1
ALLEN
WRENCH**

STEP 2

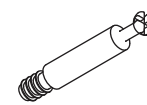
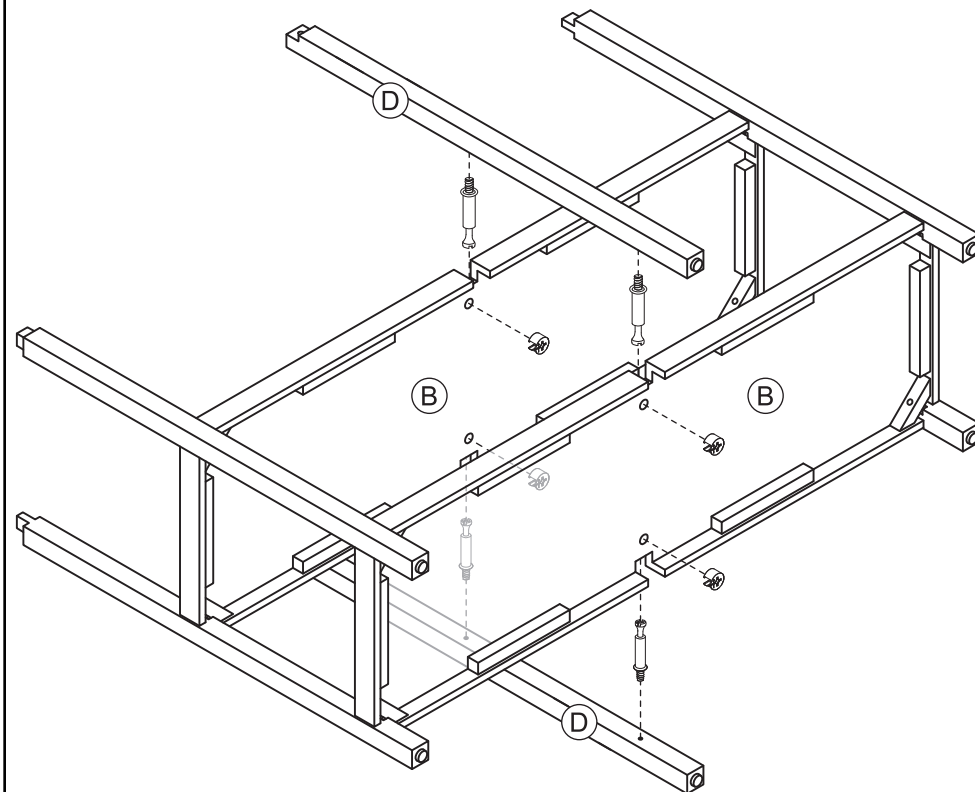

**H6 x 4
CAM BOLT**

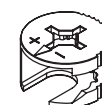

**H7 x 4
CAM**

STEP 3A

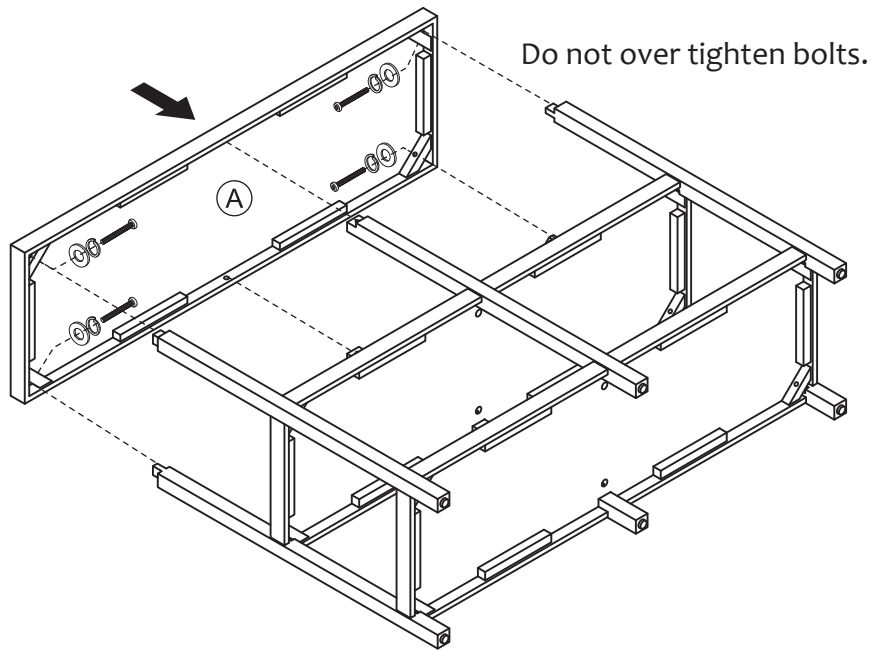

**H1 x 4
LARGE
BOLT**

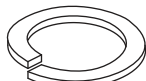

**H3 x 6
LOCK
WASHER**



**H4 x 6
WASHER**

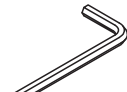

**H5 x 1
ALLEN
WRENCH**

STEP 3B



**H2 x 2
SMALL
BOLT**

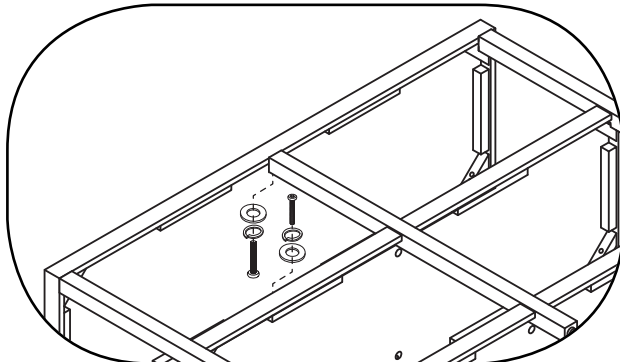

STEP 4

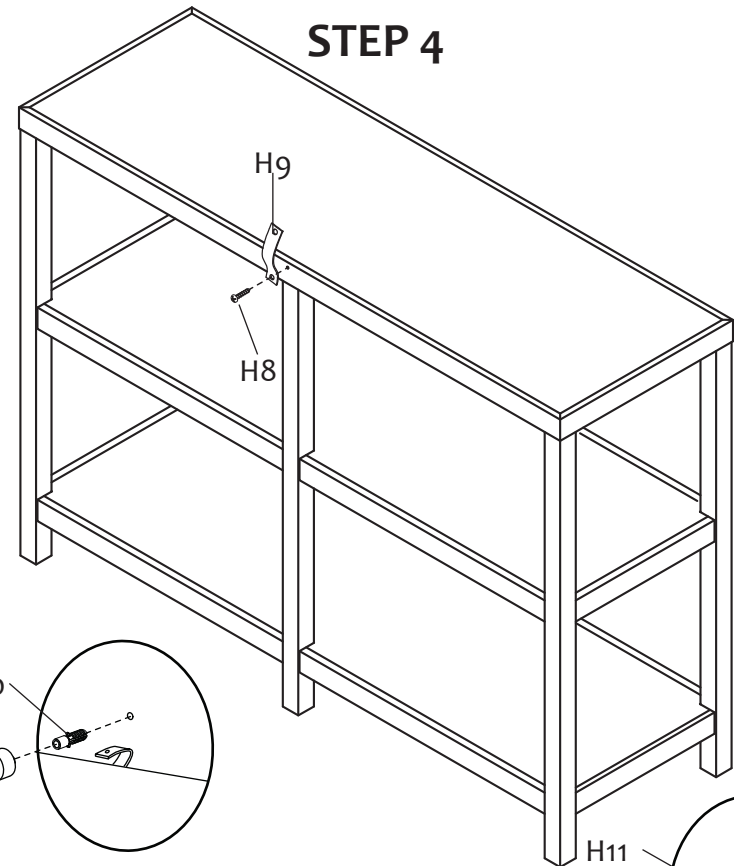

H10



Position against wall
Mark position of strap hole
on wall
Drill 1/4" hole
tap in wall anchor

H11

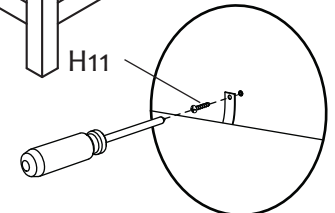

Fasten anti-tip strap with
wall screw provided

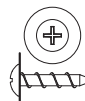

**H8 x 1
TRUSS HEAD WALL STRAP
SCREW**



H9 x 1

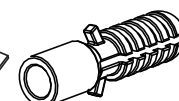

**H10 x 1
WALL
ANCHOR**

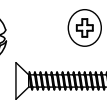

**H11 x 1
WALL
SCREW**

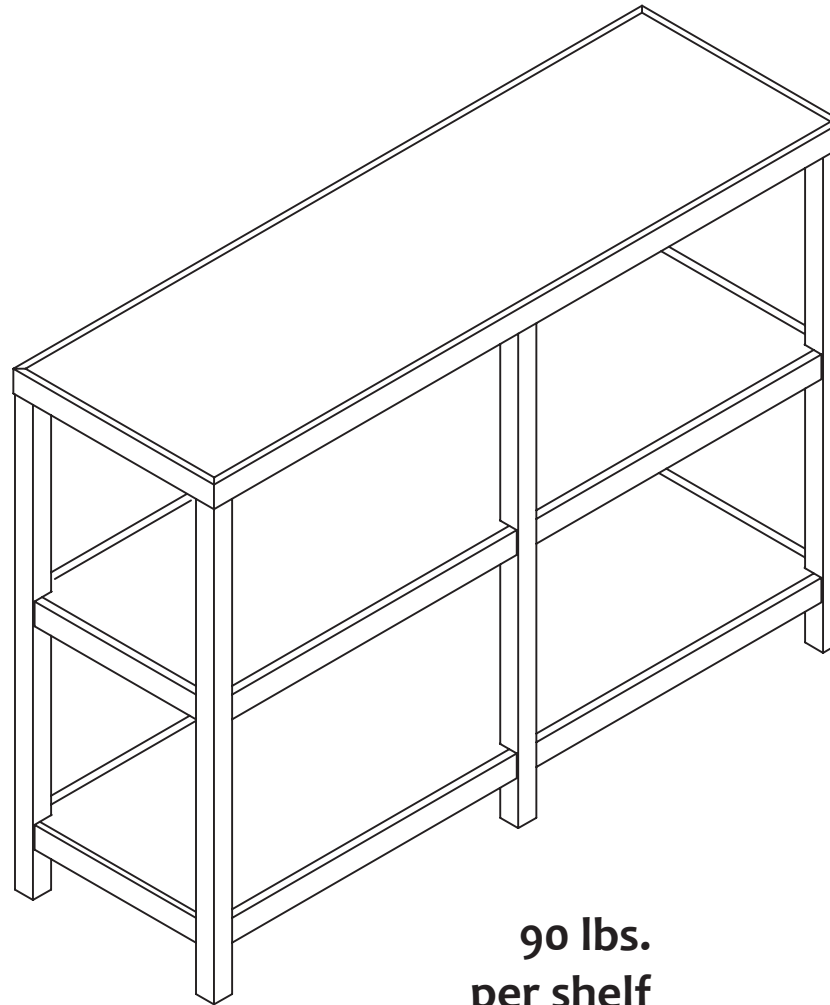

**90 lbs.
per shelf**

WARNING: Do not exceed the recommended weight limits on the designated panels. Exceeding these limits could cause sagging, possibly resulting in failure of product or bodily injury. Severe injury may occur if furniture tips over. Never allow children to climb or play on this product. Place heaviest items on lower shelves and as far back as possible, never overload product.